

SF36 - Series Earth Leakages

The SF36 is a three phase heavy duty industrial earth leakage circuit breaker available as a surface mount and CBI Mini Rail mount device. This earth leakage circuit breaker is available with earth leakage sensitivity of 30 mA.



SF36A
 Mini Rail Mount
 Surface Mount



SF36C
 Mini Rail Mount
 Surface Mount

Features

- Hydraulic-magnetic technology
- 100% rating capability, independent of ambient temperature
- VC 8035 compliant
- AS/NZS 3111 and AS/NZS 3190 compliant
- Immune to pulsating DC load current
- Ratings 10 to 80 A
- Earth Leakage sensitivity 30 mA
- Three pole plus switched neutral earth leakage protection
- Switches all active and neutral poles
- Precision tripping characteristics
- Reset immediately after overload
- Suitable to use for electrical isolation
- Surface mount & Mini Rail mount
- 55 mm front escutcheon

Applications

- Mining, heavy industrial and commercial applications requiring high sensitivity earth leakage protection from electrical shock and fire hazards
- Telecom / datacom equipment
- Lighting control
- UPS equipment
- Alternative energy equipment
- Mobile power generation equipment
- Railway signalling equipment

Approvals

VC 8035



AS/NZS 3111



AS/NZS 3190

SF36 - Series Earth Leakages

Technical Data

Product Type	SF36A	SF36C
Approvals	VC 8035	
Number of Poles	3+N	3+N
Standard Ampere Ratings	10 to 80 A	80 A
Sensitivity	30 mA	30 mA
Rated Voltage	415 V	415 V
Rated Interrupting / Withstand Capacity	5 kA -	- 5 kA
Time Delay Curves	2	2

Product Type	SF36AE	SF36CE
Approvals	AS/NZS 3111, AS/NZS 3190	
Number of Poles	3+N	3+N
Standard Ampere Ratings	10 to 80 A	80 A
Sensitivity	30 mA	30 mA
Rated Voltage	415 V	415 V
Rated Interrupting / Withstand Capacity	6 kA -	- 6 kA
Time Delay Curves	2	-

Product Type	SF36
Operating Temperature Range	-40 °C to +85 °C
Mounting Options	CBI Mini Rail, surface mount
Time Delay Curves	2
Endurance	1500 electrical operations (AS/NZS 3111, AS/NZS 3190)
Dielectric Strength	1480 V (single pole) / 1830 V (multi pole), 50 Hz for one minute after testing
Weight	960 g (unpacked)
Humidity	35 to 85% relative
Altitude	Certification tests done at altitude ≈ 2000 metres. Will operate at higher altitudes.
Shock	16 G (IEC 600068-2-27)
Vibration	2 G (IEC 600068-2-27) (sinusoidal wave)
Flammability	I3 - Ignition does not persist at 850 °C after glow wire is withdrawn with an oxygen index of ≥ 28
Toxicity	F1 - Smoke index of ≤ 20 which determines the fume class
Pollution Degree	PD2 - Normally only non-conductive pollution occurs. Temporary conductivity caused by condensation is to be expected.

Earth Leakage	Wire Size mm ² (IEC)	Torque (IEC)	Comments
3+N	0.75 - 35 mm ²	2.5 Nm	Pozidriv #2 Combi head

SF36 - Series Earth Leakages

Ordering Information

Example Code: S-F-36-AE--2--80A-30mA-415V---

Group	1	2	3	4	5	6	7	8	9	10
Requirement	S Frame	Type F	3 pole + N	Overload	No auxiliary	Medium delay curve 2	Current rating 80 A	Sensitivity 30 mA	Voltage 415V AC	No special termination
Long Code	S	F	36	AE	-	2	80A	30mA	415V	-

Group	Code	Description	Comments
Group 1: Frame Type	S	117 mm wide earth leakage	
Group 2: Product Type	F	415 V AC, 6 kA	
Group 3: No of Poles	36	Three pole plus switched neutral (3+N)	SF36
Group 4: E-L Type	AE	Overload (auto tripping)	White and green handle
	CE	Switch disconnecter	Green handle
Group 5: Auxiliary / Additional Pole	-	Not applicable	Use this code if no auxiliary used
	A	Auxiliary switch	
Group 6: Time Delays	2	Medium time delay	
Group 7: Current Ratings	Code / Description		Comments
	10, 16, 20, 25, 32, 40, 63, 80 A		SF36 Ratings available vary depending on certification * Other ratings are available as special orders. Check availability.
	80 A		SF36
Group 8: Sensitivity	30mA	30 mA	Standard
Group 9: Voltage	415V	415V AC	
Group 10: Special Termination	-	No special termination	

For options not listed, please contact CBI

SF36 - Series Earth Leakages

Time Delay Curves

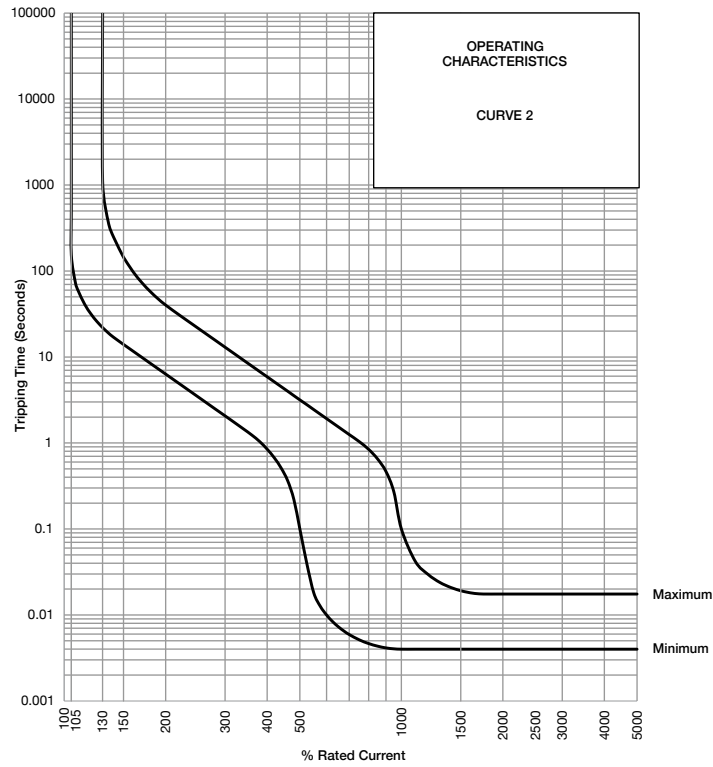

* The published time delay curves are generated at 30°C ambient temperature with the Circuit Breaker mounted in the up-right position. The “must hold”, “must trip” and “instantaneous trip” current values are not affected by temperature, although delay time for the other operating current values may have to be adjusted using the temperature compensation curve which is available on request.

SF36 - Series Earth Leakages

Outline Dimensions: SF36

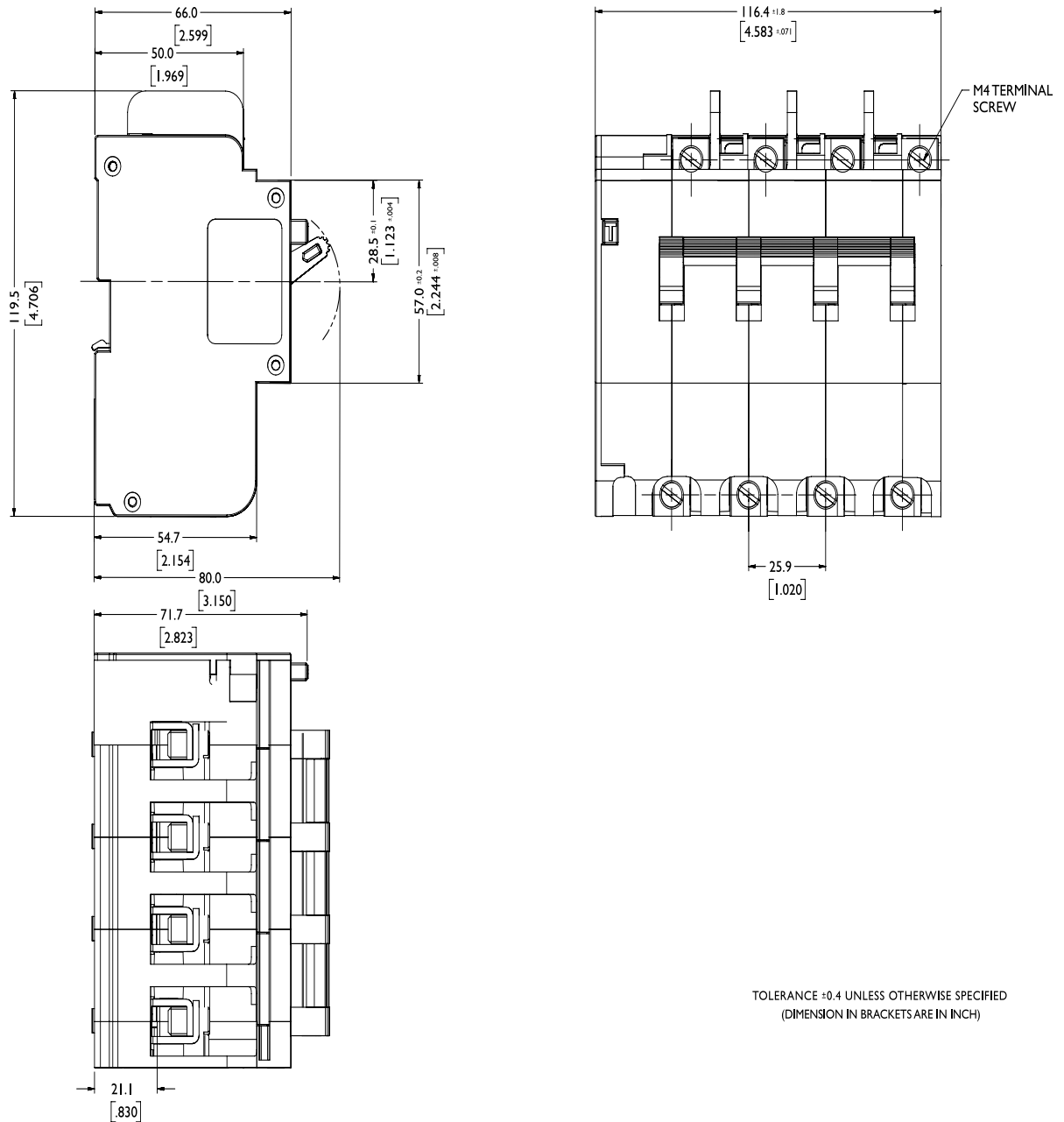

Please review our Customer Terms and Conditions on www.cbi-lowvoltage.co.za

© 2016.09 CBI (Pty) Ltd. All Rights Reserved.

All rights reserved. Unless otherwise indicated, all materials on these pages are copyrighted by CBI (Pty) Ltd. No part of these pages, either text or image may be used for any purpose other than personal use. Therefore, reproduction, modification, storage in a retrieval system or retransmission, in any form or by any means, electronic, mechanical or otherwise, for reasons other than personal use, is strictly prohibited without prior written permission. CBI (Pty) Ltd reserves the right to alter any details of this document without notice and while every effort is made to ensure the accuracy of the content, no warranty is given as to the accuracy of this document and no responsibility will be accepted for error or misinterpretation and any resulting loss.

AUSTRALIA

CBI-electric: Australia
27 Wedgewood Rd, Hallam
Victoria 3803 Australia
Tel: +61 3 8752 9300
Fax: +61 3 9796 5407
Email: sales@cbi-electric.com.au
Website: www.cbi-electric.com.au

SOUTH AFRICA

CBI-electric: low voltage
Tripswitch Drive Elandsfontein
Gauteng South Africa
Tel: +27 11 928 2000
Fax: + 27 11 392 2354
Email: cbi@cbi-electric.com
internationalsales@cbi-electric.com
Website: www.cbi-lowvoltage.com

USA

CBI-electric: North America
35 E. Uwchlan Ave Suite 328
Exton PA 19341 USA
Tel: +1 610 524 9949
Fax: +1 610 524 9945
E-mail: info@cbibreakers.com
Website: www.cbibreakers.com